

**Hernik**

# USER MANUAL

**IPAI** **NXT**



version: 01-2019

# TABLE OF CONTENTS

<b>I. General information</b>	Seite
1.1 Introduction	2
1.2 Purpose and indication	2
1.3 Relevant information	3
1.4 Declaration of conformity	3
1.5 Warranty	3
1.6 Service and repair	3
1.7 Practical instructions	3
1.8 Installation in the car	4
1.9 Adjusting the head rest	4
1.10 Using the 3-point-harness	5
<b>II. Safety instructions</b>	
2.1 Safety instructions	7
<b>III. Handling and functions of the basic seat</b>	
3.1 Adjusting the internal 5-point-belt	8
3.2 Using the separate adjusters	8
3.3 Adjusting the height of the back rest	9
3.4 Adjusting the angle of the back	9
<b>IV. Using the optional accessories</b>	
4.1 ISOFIX-adapter	10
4.2 Clamp bow	11
4.3 Security tray	12
4.4 Lateral supports	12
4.5 Abduction block	13
4.6 Angular adjustment	13
4.7 Foot rest / foot roll	14
4.8 Swivel	14
4.9 Protection mat	15
4.10 Belts to connect the chest straps	15
<b>V. Guarantee</b>	16
<b>VI. Labeling</b>	16
<b>VII. Maintenance &amp; product care</b>	
7.1 Pull off the cover	17
<b>VIII. Technical characteristics</b>	18

## I. General information

### 1.1 Introduction

You have chosen the car seat "IPAI-NXT" and get hereby a high quality product from our house. We would like to thank you for your trust in us.

To make sure you find joy with this product and to ensure it helps you to make everyday life easier, we present you this manual. It shows you the correct and simple usage and the necessary care and maintenance. To avoid damage due to operator error and to ensure best use, please read the following instructions carefully. If you have any questions or problems, please contact your dealer. We wish you a trouble-free use and hope that our products meet your expectations.

We reserve the right to make technical changes to the version described in this manual.

Before installing in your car and using it for the first time, please read and follow the installation instructions on pages 4 - 6. Please ensure that the instructions for use remain with the product and are therefore available to everyone who use the seat.

Yours

HERNIK GmbH

### 1.2 Purpose and indication

The IPAI-NXT was developed for the transport of children with special needs in cars. Children with poor head or trunk control (eg infantile cerebral palsy, muscular dystrophy, hypotension) can be supported in their posture by means of individually positioned thorax pads and special upholstery which ensures a safe transportation.

Important optional accessories can be used to address specific needs such as: the seat angle or the installation of a stable abduction wedge or a footstool. More in chapter IV.

## I. General information

### 1.3 Relevant information

The IPAI-NXT car seat for disabled children consists of two modules:

1. A standard child car seat from Römer-Britax (please refer to the manufacturer's manual for use).
2. Adaptation module with accessories, which offers the possibility to equip the car seat according to individual needs. Please observe the instructions for use from HERNIK GmbH.

### 1.4 Declaration of conformity

HERNIK GmbH declares in sole responsibility that car seat "IPAI-NXT" complies with the Essential Requirements (Appendix 1 of Directive 93/42 EEC). The product is marked with the CE mark according to the above mentioned directive.

### 1.5 Warranty

A warranty can only be accepted if the product is used under the specified conditions and for the intended purposes. The manufacturer is not liable for damage caused by components and spare parts which were not approved by the manufacturer.

### 1.6 Service and repair

Service and repairs on the IPAI-NXT may only be carried out by specialized dealers. If you have any problems, contact your local dealer. For repairs, you will only receive original spare parts.

### 1.7 Practical instructions

The car seat will be delivered fully assembled. Upon delivery, the dealer will instruct the user how to use the device by using the manual. The specialist dealer should install together with the user the car seat in the car and if available adjust the Isofix strap or the clamp.

When installing the car seat, it is best to hold it with one hand in the center of the front and the other at the top. In order to achieve an optimal sitting position, it is necessary to adjust the car seat individually to the circumstances of the child. This should always be done by the dealer.

## I. General information

### 1.8 Installation in the car

Place the child seat on the vehicle seat. Make sure that the backrest (07) lies flat against the backrest of the vehicle seat.

**Tip!** If the headrest of the vehicle seat disturbs, remove it.

### 1.9 Adjusting the head rest

1. A correctly adjusted headrest (05) ensures the optimal course of the car's diagonal belt (3-point belt) and offers your child maximum protection. The headrest (05) must be adjusted so that there is still room for two fingers between the shoulders of your child and the headrest (05). This allows you to adjust the height of the headrest to your child's height:
2. Grasp the adjustment handle (06) on the back of the headrest (05) and pull it up. Now the headrest is unlocked.
3. Now you can push the unlocked headrest (05) to the needed height. As soon as you release the adjustment handle (06), the headrest (05) locks.
4. Place the child safety seat on the vehicle seat.
5. Have your child sit in the child car seat and check the height. Repeat this process until the headrest (05) is at the correct height.

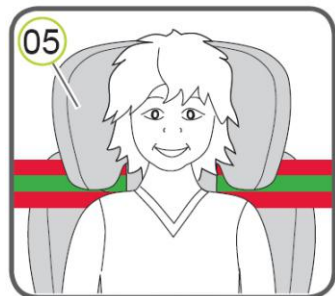
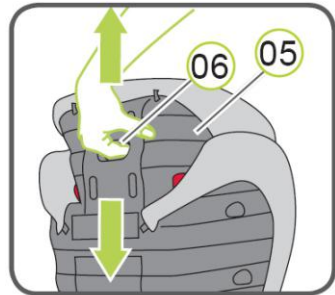
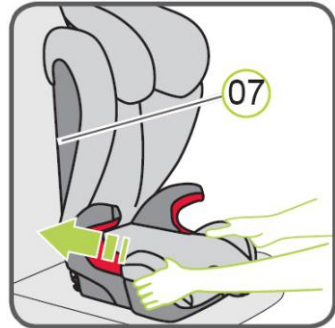

## I. General information

### 1.10 Using the 3-point-harness (Gr. III)

To be able to absorb the enormous forces during an accident, the IPAI-NXT must be secured with the vehicle's three-point belt according to ECE 44, R14 and R16. An ISOFIX connection alone is not enough.

1. Put your child in the child seat - ideally by turning the seat by 90 ° (option: swivel adapter).

2. Pull out the vehicle belt and guide it (in front of your child) to the seat belt buckle (19).



**DANGER!** Make sure that the vehicle belt is not twisted, otherwise the full protective effect of the restraint system is not given anymore.

3. Lock the latch in the car buckle (19) with a CLICK.

4. Place the Diagonal Belt (18) and Lap Belt (17) on the side of the Car Seat Belt Buckle (19) in the light red belt guide (01) of the Seat Cushion.



**DANGER!** The Car Seat Belt Buckle (19) must not be between the light red belt guide (01) and the arm rest.

5. Place the lap belt (17) on the other side of the seat cushion in the light red belt guide (01).

**DANGER!** The lap belt (17) must run as low as possible on both sides over the hips of your child.

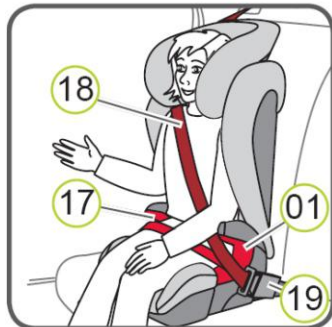

## I. General information

6. Insert the diagonal belt (18) into the dark red belt holder (02) of the headrest (05) until it is completely and untwisted in the belt holder (02).

**Tip!** If the backrest (07) hides the belt holder (02), you can adjust the headrest (14) upwards. After you inserted the diagonal strap (18) you can set the headrest (05) back to the correct height.

7. Make sure that the diagonal strap (18) runs over your child's collarbone and does not touch the throat.

**Tip!** You can adjust the height of the headrest (05) also while the seat is in the car.

Before every drive, check that ...

- ▶▶ the child safety seat is securely fastened;
- ▶▶ the lap belt (17) runs on both sides of the seat cushion in the light red belt guides (01),
- ▶▶ the diagonal belt (18) on the side of the buckle (19) also runs in the light red belt guide (01),
- ▶▶ the diagonal strap (18) runs through the dark red belt holder (02) of the headrest,
- ▶▶ the diagonal belt (18) runs diagonally to the back,
- ▶▶ the straps are tight and not twisted,
- ▶▶ The car's buckle (19) is not in the light red belt guide (01) of the seat cushion.

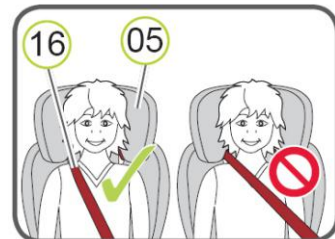
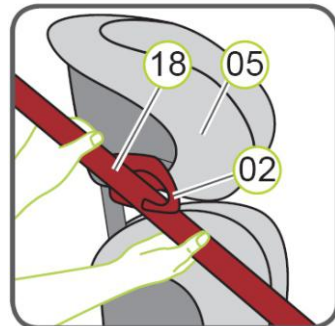

## II. Safety instructions

- Before use, the components must be checked for perfect function and condition.
- The instructions for use must always be carried on the child car seat.
- The safety of your child is only guaranteed if the seat is installed correctly and if the child is fixed exactly.
- The straps must be laid tight and without twisting.
- The 3-point safety belt is to be guided through the provided belt guides and is supposed to surround the seat tightly.

Please check:

- A) whether the seat belt is securely placed in the belt guide
- B) whether the belt buckles are locked correctly
- C) that no textiles are impacted
- Make sure that no solid objects like pins, belt buckles, etc. are placed between child and seat belt. This could lead to injuries in the event of accidents.
- Explain to your child how important it is to be well-secured and that the course of the straps do not change. It shouldn't pull on the straps nor open the belt buckles.
- Do not make any changes to the car seat, otherwise you risk your child's safety.
- The car seat must not be damaged by moving parts in the car or through doors.
- Never leave your child alone in the child car seat.
- Inform your passengers how your child can be taken out of the seat after an accident.
- After an accident, the entire child car seat has to be renewed.



### III. Handling and functions of the basic seat

#### 3.1 Adjusting the internal 5-point-belt

First select one of the two available positions for the belt buckle **1**! For this purpose, the seat cover must be loosened on one side to get to the location underneath. Then put your child in the car seat and make sure that it sits with the hip at the back.

Now put the straps over the child's shoulders. If the strap length is insufficient, lift the cover **2** and press gently on the metal rocker, so that the straps in the shoulder area can be adjusted. Be careful not to pinch the belt by pressing too hard!

Then insert the two metal tongues into the belt buckle **3** until they click into place with a click. Then tighten the strap system by pulling on the narrow strap **4**, which is located between the legs of your child, until a stable position is found.



#### 3.2 Using the separate adjusters

Optionally, it is possible to tighten the belt by means of two separate belt adjusters. Instead of pressing on the metal rocker **2**, press the gray button on the belt adjuster **5** to loosen the belt system.

Then pull on the strap end to adjust the straps individually.

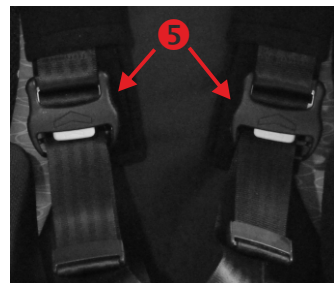

### III. Handling and functions of the basic seat

#### 3.3 Adjusting the height of the back rest

Press the release latch in the handle **1** to move the headrest up or down. Make sure that the child's head never looks over the headrest!

Adjust the belt crossbeam of the 5-point belt so that the belt runs horizontally - see **3**! Open the screw connections **2** on both sides. If the height is adjusted correctly you can tighten the screws again.



#### 3.4 Adjusting the angle of the back

It is possible to adjust the back angle stepless and lock it in any position. This ensures that the car seat is stable in any position. Open the two quick releases **1** and move the back to the desired position. Then close the quick release levers to fix the angle.

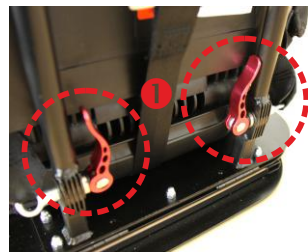

## IV. Using the optional accessories

### 4.1 ISOFIX-adapter

#### Installation:

1. Let the installation of the seat and its adjustment been demonstrated to you by the technician.
2. Open the setscrews **1** on the left and right and pull the bracket out to the rear.
3. Adjust the back rest of the car's seat to the required angle, taking advantage of the space created to the car's back pad. Slide the ISOFIX adapter on both sides backwards in the direction of the backrest until you hear the locking of the two ISOFIX tongues **2** in the vehicle's ISOFIX mounting (two clicks).
4. Push the car seat towards the backrest of the vehicle until both touch and are slightly under tension. This prevents vibrations while driving.
5. Close the two setscrews **1** left and right. In addition, the two ISOFIX tongues must be protected against unattempt opening, which is why both screws **3** must be tightened.
6. Ensure that both ISOFIX tongues are engaged by a double-sided pulling test.

#### Removal Note:

1. Open the two screws **3**.
2. Move them forwards in the direction of the car seat, releasing the grid connection of the system. It may be necessary to compensate for the pressure of the seats padding so that the connection can be solved.
3. The car seat can now be removed from the vehicle.

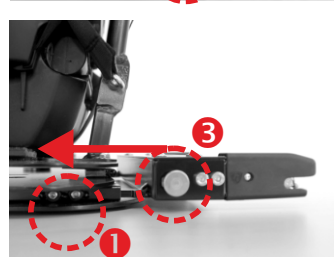
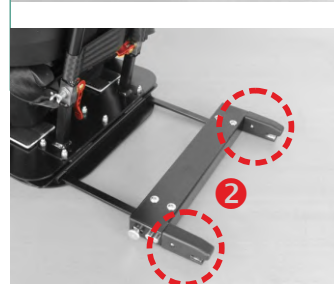
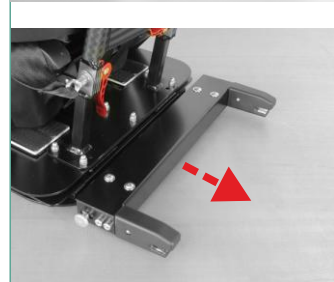
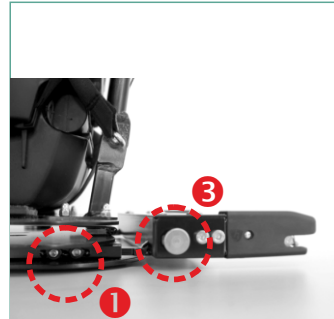

## IV. Using the optional accessories

### 4.2 Clamp bow

#### Installation:

1. Let the installation of the seat and adjustment of it be shown to you during the delivery.
2. Open the setscrews ❶ on the left and right and pull the bracket to the rear.
3. Adjust the back rest of the car's seat to the required angle, taking advantage of the space created to the car's back pad. Now push the clamp on both sides backwards in the direction of the backrest, until it sinks into the gap of the car seat and seat upholstery and remains firm.
4. Push the car seat against the backrest of the vehicle until it rests flat.
5. Now close the two setscrews ❶ left and right.
6. Whether the offset of the bow must be directed upwards or downwards depends on the construction of the respective passenger car seats.

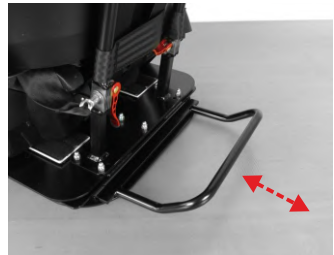
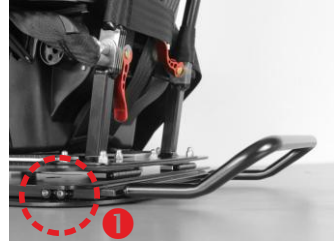

#### Removal Note:

1. Pull the car seat including the clamp out of the gap of the car seat.

## IV. Using the optional accessories

### 4.3 Security tray

Installation:

1. Let the installation of the seat and adjustment of it be shown to you during the delivery.
2. Put the support and safety pad ❶ on the car seat after sitting your child into it and strapping it on.
3. Secure the padding using the supplied Velcro straps ❷, which are fastened to the back of the car seat.
4. Your child's arms should rest on the table, which leads to an upright seating position. This supports the upper body.
5. Make sure to avoid the risk of toys, which may be on the upholstery. Do not use hard, solid or even sharp-edged objects!



### 4.4 Lateral supports

1. HERNIK GmbH is not allowed to injure (drill, screw) the body of the IPAI-NXT. Nevertheless it was very important to us to offer lateral supports ❶ for children with weak trunk muscles, so we decided for a fixation solution, which uses Velcro for sufficient stability and also provides flexibility.
2. In order to change the position of the pads, it must first be carefully released by gently turning the Velcro connection. Afterwards, the pad can be arranged freely.



**IMPORTANT:** For a stable fit, the pad should be pressed with high pressure while turning back and forth on the back of the IPAI-NXT. This creates a firmer hold of the Velcro elements!



## IV. Using the optional accessories

### 4.5 Abduction block

1. The abduction wedge **2** helps your child to reach a predetermined distance between the knees. In order to loosen or tightening the 5-point belt, the wedge must be removed. Open the clamp **1** and remove the wedge upwards.
2. The wedge should be against the seat upholstery as shown in the picture. The depth of the wedge can be adjusted. For this purpose, both hexagon screws must be opened and offset under the seat.
3. The wedge should always be used while driving (if chosen as an option), otherwise your child could be injured by the mounting.
4. The lever **1** can be changed in its position by gently pulling it forward without moving the screw connection. Make sure it is up and not out of the way, otherwise your child's calves may come into contact with it.



### 4.6 Angular adjustment

1. If the seat angle provided by the vehicle seat is insufficient, the seat angle of the car seat can be increased by the (extended) child seat angle adjustment **1**. For this purpose, the screw **2** left and right has to be opened and another hole to be selected. Then tighten the screws back.
2. For safety reasons, here is no quick release possible!

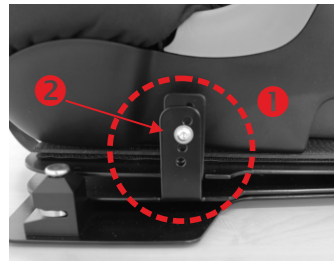

## IV. Using the optional accessories

### 4.7 Foot rest / foot roll

1. The tabs **1** are fixed below the car seat by means of set screws on the base mount, so that the depth can be adjusted.
2. The angle of the handrails can be varied by opening the quick release lever **2**. Care should be taken to ensure that the levers are in a position that does not cause harm!
3. To adjust the height of the footrest, the screws **3** on the left and right must be opened. Now the height can be stepless selected. Then please tighten the screws again.



### 4.8 Swivel

1. To simplify the daily transfer to the vehicle, we recommend our swivel adapter, which let the car seat turn outwards by 90°. For technical reasons, only ONE direction of rotation is possible. For a later change in the other direction, the car seat must be rebuilt in our house. The use of the ISOFIX adapters or the clamp are recommended!

2. To turn the chair, the handle **1** must be pulled up and the chair moved at the same time. The optional footrest stops to avoid collisions with the front passenger seat and the B-pillar.

Pay attention when rotating your child's legs!

3. After the transfer, simply turn the IPAI-NXT back to the starting position and pay attention to the "click" sound, in which the tongue **2** snaps back into the catch.



## IV. Using the optional accessories

### 4.9 Protection mat

1. Position the mat on the car seat without blocking the ISOFIX connectors.
2. Place the IPAI-NXT in the center of the protective mat and secure it as described in chapter 3.1.



### 4.10 Belts to connect the chest straps

1. Set the belt at the height of your child's chest. Keep a sufficient distance to the neck! To prevent the belt from slipping, the insides are equipped with velcro. To solve this, loosen it with your fingers.
2. Now adjust the width of the belt by threading the belt out of the slider **2** and then tighten the belt buckle **1**. Now secure the loose end of the strap by means of the slider **2** to prevent unwanted loosening of the strap.

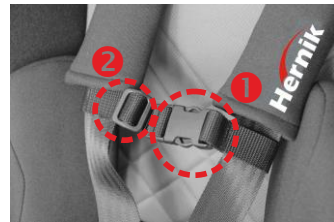



## V. Guarantee

Hernik products are designed and manufactured in accordance with strict quality standards. If, in exceptional circumstances, you have cause for complaint, Hernik GmbH guarantee in accordance with the terms and conditions of delivery:

- 24 months warranty on all solid parts, from date of delivery.
- 12 months warranty on all moving parts, from date of delivery.

For parts that were not manufactured by Hernik GmbH, please refer to the warranty policy of the respective manufacturer (Römer-Britax Kindersicherheit GmbH). Claims under this guarantee are subject to the device being properly installed and used in accordance with the instructions provided.

Warranty is void where modifications or improper repairs, without prior consultation with the manufacturers are carried out. Warranty is void where a device is improperly fitted.

Further claims, for whatever legal reason, in particular, claims for direct or indirect damages are excluded.

## VI. Labeling

On the back you'll find the following labeling:



## VII. Maintenance & product care

### 7.1 Pull off the cover

Please ensure that you only use original BRITAX-RÖMER or HERNIK replacement seat covers, as the seat cover is an integral part of the child safety seat and fulfills important functions to ensure the perfect functioning of the seat. Replacement seat covers are available from your Dealer.

The cover can be removed and washed with a mild detergent in the fine washing program of the washing machine (30 ° C). Please refer to the instructions on the washing label of the cover.

The plastic parts can be cleaned with soap and water. Do not use harsh cleaning material (such as solvents).

**DANGER!** The child safety seat must not be used without the seat cover.

1. Move the headrest of the car seat to its uppermost position.
2. Unhook the hooks (20) on the back of the backrest (07).
3. Pull off the upper part of the cover.
4. Suspend the reference loops (21) at the bottom at the back of the backrest (07).
5. Remove the cover from the seat cushion (03). Do the same with the headrest cover.
6. Disconnect the reference loops (21) at the back of the headrest (05)
7. Suspend the hooks (20) on the front of the backrest (07)
8. Pull off the cover of the headrest (05).

▶▶ The cover can now be washed.

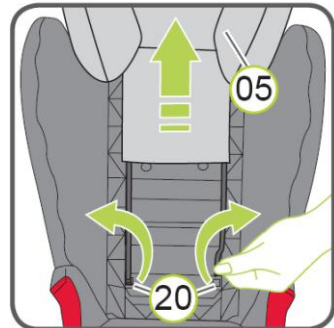
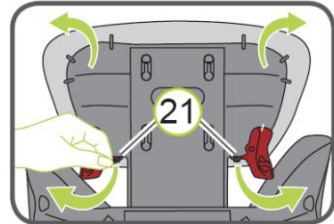
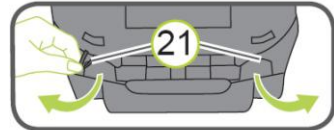
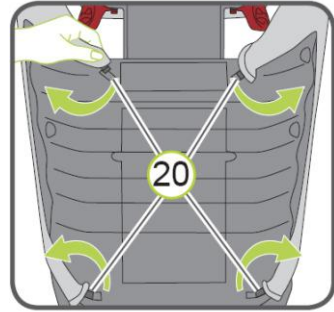

## VIII. Technical characteristics

	IPAI-NXT <b>WITHOUT</b> extra cushion	IPAI-NXT <b>WITH</b> extra cushion
SEAT WIDTH (pelvis)	31 cm	26 cm
SEAT WIDTH (knee)	34 cm	34 cm
SEAT DEPTH	30 cm	27 cm
BACK HEIGHT	41 - 54 cm	38 - 51 cm
CROWN HEIGHT	59 - 74 cm	56 - 71 cm
HEIGHT LATERALS	20 - 33 cm	17 - 30 cm
DISTANCE LATERALS	14 - 28 cm	
angle	85° - 160°	
total height	68 - 88 cm	
total width	51 cm	
total depth	42 cm	
weight	ab 7,0 kg	
capacity	36 kg	

### Standard equipment:

- 5-point harness with padded buckle pad (height adjustable!) and belt protectors
- Headrest height adjustable
- comfortable back and headrest padding with removable cover (modelable foam!)
- three-part basic cover removable and washable at 30 ° C
- aluminum / steel construction, incl. back angle adjustment and stable base plate; back angle stepless adjustable and lockable



HERNIK GmbH  
Bodenseestrasse 25  
83059 Kolbermoor • Germany

☎ +49 8031-2068044 • 📠 +49 8031-2069215  
✉ info@hernik.de • 🌐 www.hernik.de